

ROUND INSERTS

SPECIFICATION

MATERIALS

PE

STANDARD COLOURS

Black

TECHNISCHE DATEN

MATERIAL

PE

STANDARDFARBEN

Schwarz

SPECIFICATION

MATIERES

PE

COLORIS STANDARD

Noir

ESPECIFICACION

MATERIALES

PE

COLORES ESTANDAR

Negro

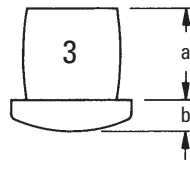
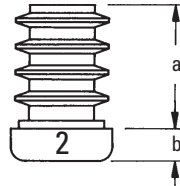
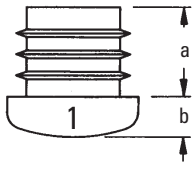

HEAVY DUTY RIBBED (1)

NO.	Ins. x Gauge	mm	a	b
55051011B0	1/2 x 18/16	12.5 x 1.25/1.5	-	-
55111011B0	5/8 x 20/16	16 x 1/1.5	-	-
55201011	3/4 x 18/16	19 x 1.25/1.5	12.75	6.25
55221011	3/4 x 14/16	19 x 2/1.5	12.75	5.75
55301011	7/8 x 18/16	22.2 x 1.25/1.5	12.75	6.25
55391011	1 x 18/16	25 x 1.25/1.5	12.75	6.25
55411011B0	1 x 14/10	25.4 x 2/3.25	-	-
55121011B0	1 1/8 x 20/14	28.6 x 1/2.0	-	-
55551011	1 1/4 x 18/16	31.7 x 1.25/1.5	12.60	6.50
55781011	-----	33.7 x 2.6/4.0	15.00	5.50
55071011B0	1 1/2 x 20/14	38 x 1/2.0	-	-
55131011B0	1 5/8 x 18/14	41.3 x 1.25/2.0	-	-
55801011	-----	42.4 x 2.6/4.0	17.50	7.50
55141011B0	1 3/4 x 20/14	44.4 x 1/2.0	-	-
55041011B0	-----	48.3 x 1.2/3.6	-	-
55821011	-----	48.3 x 3.2/5.0	19.00	8.00
55151011B0	-----	50 x 1/2.5	-	-
55061011B0	2 x 20/14	50.8 x 1/2.0	-	-
55841011	-----	60.3 x 3.2/5.0	20.50	10.00
55101011B0	2 1/2 x 18/14	63.5 x 1.25/2.0	-	-
55861011	-----	76.1 x 3.2/5.0	22.00	13.00
55081011B0	-----	88.9 x 1.8/4.0	-	-
55091011B0	-----	114.3 x 3.2/5.5	-	-



HEAVY DUTY FEET (Thick Head) (2)

NO.	Ins. x Gauge	mm	a	b
55401011	1 x 14/16	25 x 1.5/2	29.75	8.00
55501011	1 1/8 x 14/16	28.6 x 1.5/2	30.50	8.00
55601011	1 1/4 x 14/16	32 x 1.5/2	32.00	15.50
26301011	1 1/2 x 16	38 x 1.5	-	-

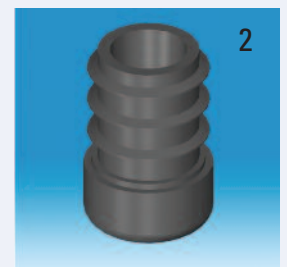

HEAVY DUTY PLAIN (3)

NO.	Ins. x Gauge	mm	a	b
25041011	3/8 x 20	10 x 1	9.50	2.50
25071011	1/2 x 20	13 x 1	12.75	3.25
25131011	5/8 x 20	16 x 1	12.00	4.00
25151011	5/8 x 16	16 x 1.5	12.00	4.00
25241011	3/4 x 16	19 x 1.5	15.00	6.25
25331011	7/8 x 14	-	15.50	6.00
25561011	1 1/16 x 10	27 x 3.25	15.00	6.25
25461011	1 1/8 x 18	28 x 1	15.00	7.25
		28.5 x 1.25		
25471011	1 1/8 x 16	28.6 x 1.5	15.00	7.25
25661011	1 5/8 x 16	41.5 x 1.5	19.00	8.75
25761011	2 x 18	50 x 1/1.25	19.00	9.50
25811011	2 x 10	50 x 3	19.00	9.50
25901011	3 x 10	75 x 3	25.50	15.00
90691011*	3 x 10	75 x 3	25.00	19.00
25931011	3 1/2 x 10	88.5 x 3.25	24.50	17.50



* Overhung shroud

* Rohrende komplett verdeckt

* Côté enveloppant

* Parte externa envolvente

SPECIFICATION MATERIALS

PE
STANDARD COLOURS
Black

TECHNISCHE DATEN MATERIAL

PE
STANDARDFARBEN
Schwarz

SPECIFICATION MATIERES

PE
COLORIS STANDARD
Noir

ESPECIFICACION MATERIALES

PE
COLORES ESTANDAR
Negro

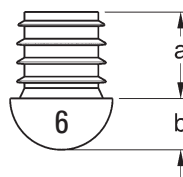
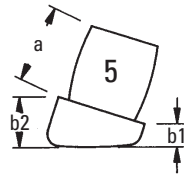
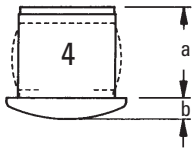

LIGHT DUTY PLAIN (4)

NO.	Ins. x Gauge	mm	a	b
24321011	1/2 x 20	13 x 1	8.75	2.50
24331011	1/2 x 18	13 x 1.25	8.75	2.50
24381011	5/8 x 20	16 x 1	8.00	2.50
24391011	5/8 x 18	16 x 1.25	8.75	2.50
24401011	5/8 x 16	16 x 1.75	8.75	2.50
24421011	-----	16 x 2	8.75	3.25
24501011	3/4 x 19/20	19 x 1	8.00	2.50
24521011	3/4 x 18	19 x 1.25	7.25	3.25
24491011	3/4 x 16	19 x 1.5	11.00	3.25
24601011	7/8 x 18	22 x 1.25	8.00	3.25
24581011	7/8 x 16	22 x 1.5	12.00	3.25
24631011	1 x 18	25 x 1.25	12.75	3.25
		25.4 x 1.25		
24641011	1 x 16	25 x 1.5	12.75	3.25

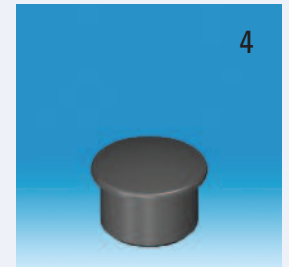

ANGLED (5)

NO.	Ins. x Gauge	mm	a	b1	b2
25171011	5/8 x 17	-	14	6	11.25
25181011	5/8 x 16	-	14	5	8.75
25201011	3/4 x 18	19 x 1.25	15.75	6	13.5
25291011	3/4 x 16	19 x 1.5	15.75	5	11
25301011*	3/4 x 16	19 x 1.5	15.5	4	12
25271011	3/4 x 16	19 x 1.5	15.5	5.5	13.5
25281011	3/4 x 14	19 x 2	15.7	5.5	11.25
26021011	7/8 x 17	-----	15.7	5.5	16.25



* Trailing edge

* Überstehende Kante

* Base élargie

* Pata más grande

DOMED INSERT (6)

NO.	Ins. x Gauge	mm	a	b
55341012		16 x 1.5	14	8
55351012		19 x 1.5	16	9.5



SQUARE INSERTS

SPECIFICATION MATERIALS

PE
STANDARD COLOURS
Black

TECHNISCHE DATEN MATERIAL

PE
STANDARDFARBEN
Schwarz

SPECIFICATION MATIERES

PE
COLORIS STANDARD
Noir

ESPECIFICACION MATERIALES

PE
COLORES ESTANDAR
Negro

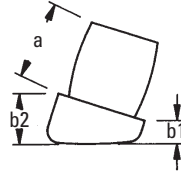
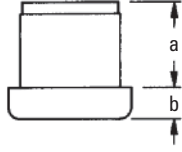
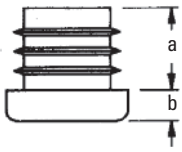

SQUARE RIBBED

NO.	Ins x Ins x Gauge	mm	a	b
59331011B0	1/2 x 1/2 x 18/16	12.7 x 12.7 x 1.25/1.5	-	-
59341011B0	5/8 x 5/8 x 18/16	16 x 16 x 1.0/2.0	-	-
59321011	3/4 x 3/4 x 18/16	19 x 19 x 1.25/1.5	12.75	4.75
59411011	-----	20 x 20 x 1.25/1.5	13.50	4.75
59451011	7/8 x 7/8 x 18/16	22.2 x 22.2 x 1.25/1.5	12.75	4.75
59601011	1 x 1 x 18/16	25 x 25 x 1.25/1.5	12.75	5.50
59801011*	-----	25 x 25 x 1.25/1.5	12.00	5.00
59021011	1 x 1 x 14/10	25 x 25 x 2/3.2	16.00	5.50
59711011	-----	30 x 30 x 1.5/2.0	15.75	5.50
59701011	1 1/4 x 1 1/4 x 18/16	32 x 32 x 1.25/1.5	16.00	6.00
59041011B0	-----	35 x 35 x 1.25/1.5	-	-
59131011	1 1/2 x 1 1/2 x 18/10	38 x 38 x 1.25/3.0	20.50	8.00
59751011	-----	40 x 40 x 1.25/2.0	12.00	5.00
59051011	-----	40 x 40 x 2.6/4.0	18.00	6.50
59161011	2 x 2 x 12/10	50.8 x 50.8 x 2.0/3.2	20.50	7.00
59071011	-----	50 x 50 x 3.2/5.0	20.00	7.00
59081011	-----	60 x 60 x 3.2/5.0	20.00	7.00
59101011	-----	70 x 70 x 3.6/5.0	20.00	8.00
59241011	-----	80 x 80 x 3.0/5.0	25.00	8.50
59261011	-----	90 x 90 x 3.6/6.3	25.00	9.00
59281011	-----	100 x 100 x 4.0/6.3	25.00	9.50
59291011B0	-----	110 x 110 x 3/5	-	-
59301011B0	-----	120 x 120 x 2.5/5	-	-

* Lighter duty than 59601011

* stopfen leichter als 59601011

* Plus léger que le 59601011

* Más Ligero que el 59601011

SQUARE PLAIN

NO.	Ins x Ins x Gauge	mm	a	b
29061011	1/2 x 1/2 x 18	12.5 x 12.5 x 1.25	8.75	3.25
29111011	5/8 x 5/8 x 18	16 x 16 x 1.25	11.00	4.00
29121011	5/8 x 5/8 x 16	16 x 16 x 1.5	11.00	4.00
28821011	3/4 x 3/4 x 14	19 x 19 x 2	15.00	8.00
27801011	1 1/8 x 1 1/8 x 18	28.5 x 28.5 x 1.25	15.00	8.75
28061011	1 1/8 x 1 1/8 x 16	28.5 x 28.5 x 1.5	15.00	8.00
28401011	2 1/2 x 2 1/2 x 10	64 x 64 x 3.5	18.25	9.50
28411011	3 x 3 x 10	75.5 x 75.5 x 3.5	23.75	9.50
28421011	3 x 3 x 8	75.5 x 75.5 x 4	23.75	9.50
29201011B0	-----	100 x 100 x 8	-	-
28711011	-----	110 x 110 x 4	25.50	8.00

ANGLED PLAIN

NO.	Ins x Ins x Gauge	mm	a	b1	b2
27511011	5/8 x 5/8 x 16	16 x 16 x 1.5	14.25	4	10
27601011	3/4 x 3/4 x 16	19 x 19 x 1.5	15.50	4	9



RECTANGULAR AND FLAT SIDED OVAL INSERTS

SPECIFICATION MATERIALS

PE
STANDARD COLOURS
Black

TECHNISCHE DATEN MATERIAL

PE
STANDARDFARBEN
Schwarz

SPECIFICATION MATIERES

PE
COLORIS STANDARD
Noir

ESPECIFICACION MATERIALES

PE
COLORES ESTANDAR
Negro

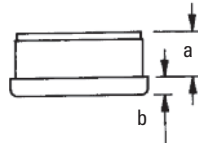
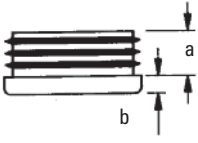

RECTANGULAR RIBBED

NO.	Ins x Ins x Gauge	mm	a	b
59771011	-----	40 x 20 x 1.25/2.0	13.00	5.00
59781011	1 7/8 x 15/16 x 18/16	-----	16.00	8.50
59181011B0	-----	50 x 20 x 1.5/2.0	-	-
59851011	-----	50 x 25 x 1/1.5	-	-
59811011	2 x 1 x 18/10	50 x 25 x 1.25/3.0	16.00	5.50
59791011	-----	50 x 30 x 2.6/3.2	20.00	7.00
59991011B0	-----	60 x 20 x 1.2/1.6	-	-
59191011	-----	60 x 30 x 1.25/2.5	15.00	5.00
59841011	-----	60 x 40 x 3.2/4.0	20.00	7.50
59881011	-----	80 x 40 x 3.2/4.0	25.00	8.50
59921011B0	-----	90 x 50 x 2/4.5	-	-
59671011B0	-----	100 x 25 x 1.5/3.0	-	-
59681011B0	-----	100 x 30 x 1.5/3.5	-	-
59691011B0	-----	100 x 40 x 2.0/4.0	-	-
59931011	-----	100 x 50 x 2.4/4.0	20.00	6.50
59941011B0	-----	100 x 60 x 2.5/4.0	-	-
59951011B0	-----	120 x 30 x 1/2.5	-	-
59961011B0	-----	120 x 40 x 3/5	-	-
59971011B0	-----	120 x 50 x 3.5/5.5	-	-
59981011B0	-----	120 x 60 x 2/4	-	-



RECTANGULAR PLAIN

NO.	Ins x Ins x Gauge	mm	a	b
29811011	1 x 1/2 x 16	25.4 x 12.7 x 1.5	9.50	4.00
28511011	1 3/8 x 5/8 x 16	34.5 x 15.7 x 1.5	15.00	6.25
28521011	1 1/2 x 3/4 x 18	37.7 x 19 x 1.25	15.00	6.25
29851011	1 1/2 x 3/4 x 16	38 x 19 x 1.5	9.50	3.25
29881011	1 3/4 x 5/8 x 16	-----	11.00	4.75
29921011	-----	60 x 20 x 1.5	12.75	4.75
28641011	2 1/2 x 1 1/2 x 10	63.6 x 38.3 x 3	18.25	9.50
28651011	3 x 1 1/2 x 10	75 x 38 x 3	21.50	9.50

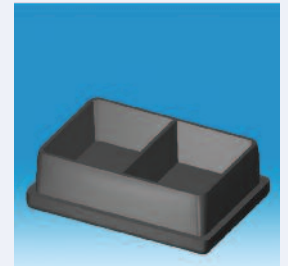

FLAT SIDED OVAL INSERTS RIBBED

NO.	Ins x Ins x Gauge	mm	a	b
93031011B0	-----	30 x 15 x 1/2.5	-	-
93001011B0	-----	40 x 20 x 1/2.5	-	-
93101011B0	-----	50 x 20 x 1/2.5	-	-
93051011B0	-----	50 x 25 x 1/2.5	-	-
90361011B0	-----	60 x 30 x 1/2	-	-
93131011B0	-----	38 x 20 x 1/2.5	-	-

